

LAKE ARROWHEAD WATERLINE REPLACEMENT

MASON COUNTY PUD NO.1

SECTION 17, TOWNSHIP 19W, RANGE 5N

TAX PARCEL: SEE INDEX SHEET

PROJECT DATA

MASON COUNTY PUD NO.1 (OWNER):

KRISTIN MASTELLER
GENERAL MANAGER
N 21971 HWY 101
SHELTON, WA 98584



BKI ENGINEERING SERVICES (DESIGNER):

WHITEWOLF ENGINEERING SERVICES (EOR):

TOM PANKAU
1315 SE GRACE AVE., SUITE 201
BATTLEGROUND, WA 98604
(630) 947-9359
TOMP@BKI.CC

RAVYN WHITEWOLF, PE, PMP, VMA
(360) 592-3445
WHITEWOLFENGINEERINGSERVICES@GMAIL.COM

GENERAL NOTES

1. LAKE ARROWHEAD WATERLINE REPLACEMENT PROJECT INVOLVES THE INSTALLATION OF A WATER LINES AND APPURTENANCES LOCATED IN THE LAKE ARROWHEAD COMMUNITY. CONTRACTOR WILL PROVIDE ALL REQUIRED TOOLS, MATERIALS, EQUIPMENT, PERSONNEL AND TESTING REQUIRED FOR PROJECT COMPLETION.
2. ALL WORK SHALL BE IN ACCORDANCE WITH MASON COUNTY PUBLIC UTILITIES DISTRICT NO. 1 "MINIMUM DESIGN STANDARDS & STANDARD CONSTRUCTION MATERIALS", MASON COUNTY PUBLIC WORKS STANDARDS, WSDOT STANDARD SPECIFICATIONS M41-10 2021, AND PROJECT PLANS. APPURTENANCES SHALL BE INSTALLED ACCORDING TO MANUFACTURER'S RECOMMENDATIONS.
3. GROUND CONDITIONS WERE DETERMINED USING UNITED STATES DEPARTMENT OF AGRICULTURE'S WEB SOIL SURVEY AND IS UP TO THE CONTRACTOR'S INTERPRETATION OF ACTUAL GROUND CONDITIONS.
4. TEMPORARY EROSION/WATER POLLUTION MEASURES SHALL BE INSTALLED PRIOR TO ANY EARTHWORK OR CONSTRUCTION ACTIVITIES IN ACCORDANCE WITH MASON COUNTY STANDARDS, WA DOE 2014 SWMMWW, AND PROJECT PLANS. SIGNIFICANT VARIATION AND DEGREE OF EROSION CONTROL EFFORT WILL BE DICTATED BY WEATHER CONDITIONS. THE CONTRACTOR SHOULD BE PREPARED TO PROVIDE EXTRA EROSION CONTROL PROVISIONS AND EFFORT DURING WET WEATHER CONDITIONS BEYOND THAT NORMALLY REQUIRED DURING DRY CONDITIONS. FINE GRAINED AND UNCONSOLIDATED SOILS ON SLOPING SITES MAY BECOME UNSTABLE WHEN SUBJECT TO EXCESSIVE MOISTURE.
5. DISTURBED AND EXPOSED AREAS FROM INSTALLATION OF INFRASTRUCTURE AND UTILITIES SHALL BE RESTORED AND STABILIZED. CONTRACTOR TO INSTALL ADDITIONAL EROSION CONTROL MEASURES AS NECESSARY TO PROTECT DISTURBED AND EXPOSED SOILS. REFER TO TESC FOR MORE DETAILS.
6. CONTRACTOR SHALL BE RESPONSIBLE FOR COMPLYING WITH ALL OTHER PERMITS, RIGHT-OF-WAYS, EASEMENTS, AND OTHER REQUIREMENTS BY THE COUNTY OR OTHER GOVERNING AUTHORITY OR AGENCY AS MAY BE APPLICABLE.
7. CALL UNDERGROUND LOCATE LINE A MINIMUM OF 48 HOURS PRIOR TO ANY EXCAVATIONS. UTILITIES SHOWN ON CONSTRUCTION PLANS ARE NOT EXACT IN LOCATION. CONTRACTOR IS ULTIMATELY RESPONSIBLE FOR PROTECTING EXISTING UTILITIES AND FOR ANY DAMAGE DONE TO THEM DURING CONSTRUCTION ACTIVITIES.
8. ALL SOIL DISTURBING ACTIVITY MUST ADHERE TO THE REQUIREMENTS OF WASHINGTON DEPARTMENT OF TRANSPORTATION STANDARD SPECIFICATIONS AND WASHINGTON DEPARTMENT OF ECOLOGY STANDARDS AND REQUIREMENTS.
9. A PRE-CONSTRUCTION MEETING SHALL BE HELD WITH MASON COUNTY PUD NO. 1 PRIOR TO THE START OF CONSTRUCTION.
10. CONTRACTOR MUST CARRY OUT HYDROSTATIC AND LEAKAGE TESTING ON THE WATER MAIN SEGMENTS PER PROJECT PLANS, WSDOT STANDARD SPECIFICATIONS M41-10, AND PUD NO. 1 OF MASON COUNTY'S "MINIMUM DESIGN STANDARDS & CONSTRUCTION MATERIALS" DOCUMENT.
11. UPON COMPLETION OF PRESSURE TESTING, THE CONTRACTOR MUST DISINFECT ALL PIPES AND FITTINGS IN THE SYSTEM ACCORDING TO WSDOT STANDARD SPECIFICATIONS M41-10 AND PUD NO. 1 OF MASON COUNTY'S "MINIMUM DESIGN STANDARDS & CONSTRUCTION MATERIALS" DOCUMENT.
12. PROJECT IS LOCATED IN A HEAVILY VEGETATED AREA WITH WET CONDITIONS. CONTRACTOR SHALL UNDERSTAND THE SITE CONDITIONS IN ITS ENTIRETY PRIOR TO PLACING BID.

SHEET INDEX

SHEET NO.	SHEET LABEL	SHEET TITLE
1	CS1	COVER SHEET
2	IN1	INDEX SHEET
3	EC1	EXISTING CONDITIONS
4	ER1	EROSION CONTROL PLAN
5	SP1	SITE PLAN
6	DT1	WATER DETAILS - TRAILS
7	DT2	EROSION CONTROL DETAILS

GENERAL NOTES (CONTINUED)

1. 2014 DEPARTMENT OF ECOLOGY STORMWATER MANAGEMENT MANUAL FOR WESTERN WASHINGTON (2014 SWMMWW) INDICATE THAT ONLY MINIMUM REQUIREMENT #2 APPLIES BECAUSE LAND DISTURBING ACTIVITIES FROM TRENCHING IS ESTIMATED TO BE LESS THAN 7,000 SQUARE FEET. ALL 13 ELEMENTS OF CONSTRUCTION STORMWATER POLLUTION PREVENTION WERE CONSIDERED AND CONTROLS WERE DEVELOPED FOR THE PROJECT SITE.
2. PROJECT IS EXEMPT FROM STATE SEPA REVIEW ACCORDING TO WAC 197-11-800(23)(B) FOR WORK LINES AND APPURTENANCES.
3. ALL LINEWORK AND EXISTING CONDITIONS SHOWN ON PLANS ARE NOT EXACT IN LOCATION AND SHOULD BE USED FOR GENERAL INTERPRETATION ONLY. THE CONTRACTOR SHALL NOTIFY THE OWNER IF DISCREPANCIES ARE FOUND IN THE FIELD THAT CONFLICT WITH CONSTRUCTION PLANS.
4. CONTRACTOR SHALL BE RESPONSIBLE FOR THE PERMITTING AND IMPLEMENTATION OF ANY TRAFFIC CONTROLS REQUIRED BY MASON COUNTY.
5. CONTRACTOR WILL COORDINATE WITH MASON COUNTY PUD NO. 1 ON TIE-IN CONNECTIONS AND FOR ANY OUTAGES REQUIRED. MASON COUNTY PUD NO. 1 WILL BE RESPONSIBLE FOR COMPLETING SERVICE CONNECTIONS REQUIRED. CONTRACTOR SHALL MAINTAIN DAILY COMMUNICATIONS WITH THE PUD IN ORDER TO COORDINATE WORK ITEMS AND TO MINIMIZE SERVICE OUTAGES TO RESIDENTS.
6. CONTRACTOR SHALL MAINTAIN A SAFE AND CLEAN WORKSITE THROUGHOUT CONSTRUCTION AND ALLOW ACCESS TO INSPECTORS OR OWNER REPRESENTATIVES.
7. CONSTRUCTION OF WATER MAINS SHALL CONFORM TO REQUIREMENTS LISTED IN WSDOT STANDARD SPECIFICATION SECTION 7-09 AND PAYMENT WILL BE MADE ACCORDING TO SECTION 7-09.5 FOR CONSTRUCTION OF WATER MAIN.
8. PRIOR TO TESTING, THE CONTRACTOR SHALL SUBMIT A FLUSHING PLAN TO THE PUD PER WSDOT 8-03.3(7) THAT DETAILS HOW THE SUPERCHLORINATED WATER WILL BE RELEASED FROM THE CONSTRUCTED WATER MAIN WHILE PROTECTING EROSION AND WATER QUALITY. TESTING ACTIVITIES SHALL NOT COMMENCE UNTIL THE PLAN IS REVIEWED AND APPROVED BY THE PUD.

UTILITY NOTE

UNDERGROUND AND OVERHEAD UTILITY LOCATIONS AS SHOWN ON THE PLANS ARE NOT IN EXACT LOCATIONS AND THE PROTECTION OF EXISTING UTILITIES ARE THE CONTRACTOR'S RESPONSIBILITY DURING CONSTRUCTION. BROWN & KYSAR INC. MAKES NO CERTIFICATION AS TO THE LOCATION OF ANY UTILITIES SHOWN ON THE PLANS.



**Know what's below.
Call before you dig.**

PROJECT OVERVIEW

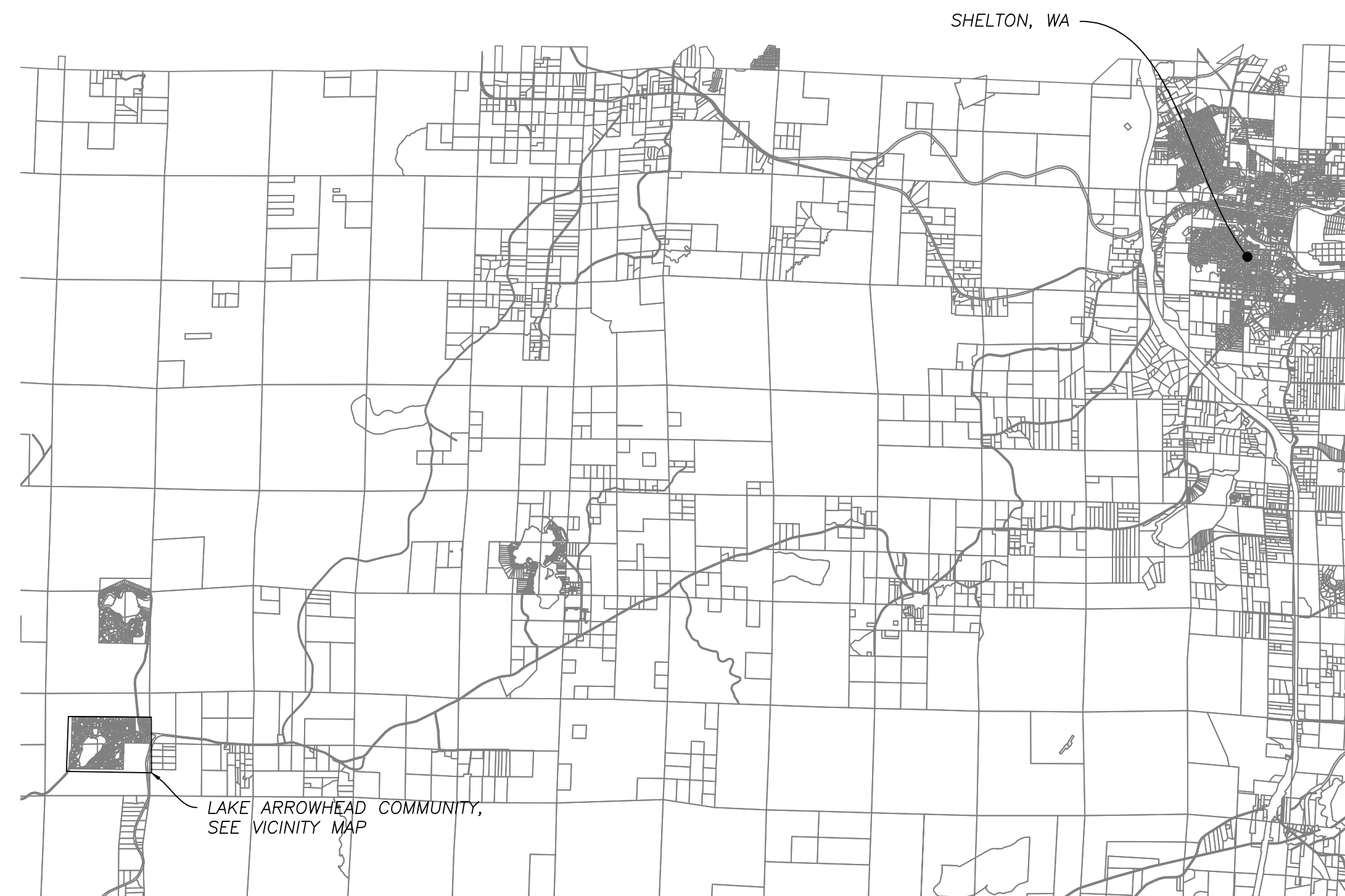

VICINITY MAP

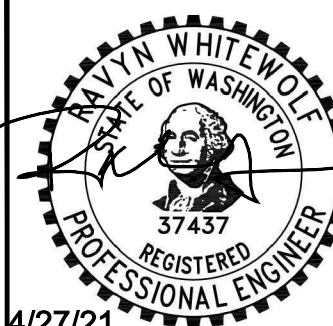
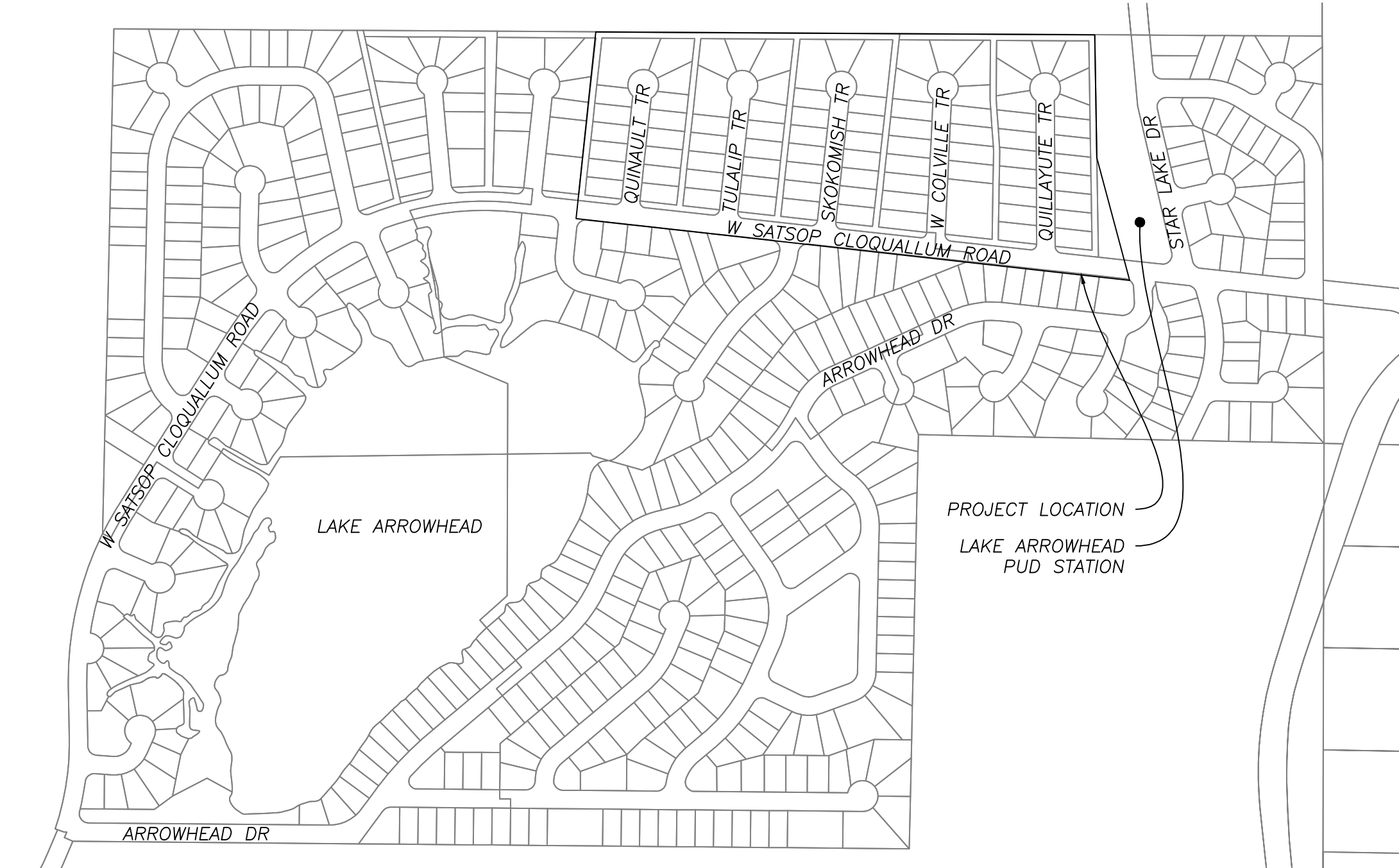
$$\overline{1'' = 500'}$$

4/27/21



BKI PROJECT NO: MA21-001

CONTRACT NO: _____ THIS LINE IS 1" LONG
AT THE CORRECT SCALE

LAKE ARROWHEAD WATERLINE REPLACEMENT COVER SHEET

MASON COUNTY PUD NO.1
N 21971 HWY. 101
SHELTON, WA 98584

0
REVISION

CS1

1 / 7

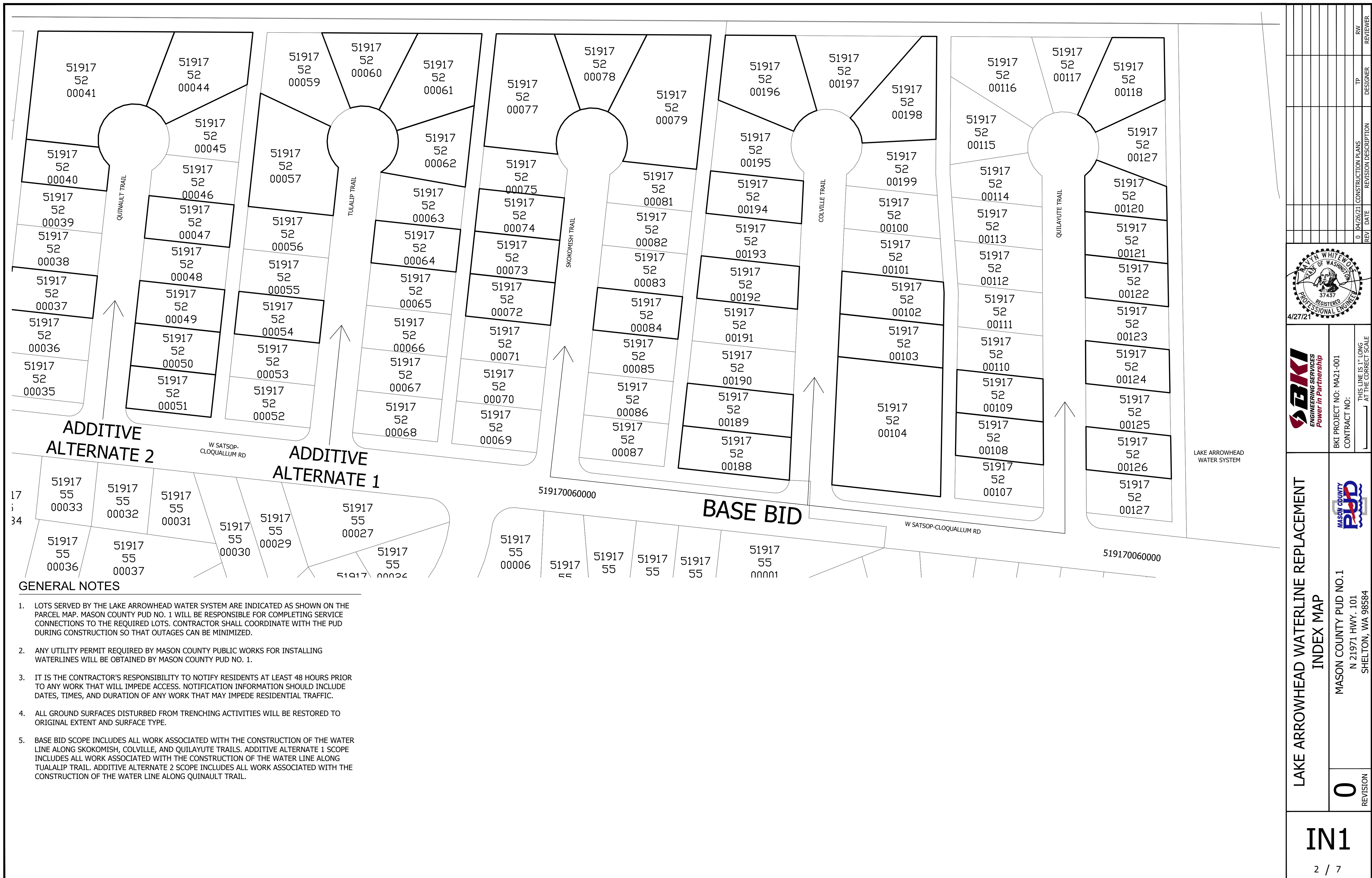

K:\Mason - PUD\BID\PROJECTS\MA21-001 Lake Arrowhead Main Replacement\10 AUTOCAD\SHEETS\Lake Arrowhead Main Replacement_10.dwg, Tom Barkau, 4/26/2021 4:11 PM

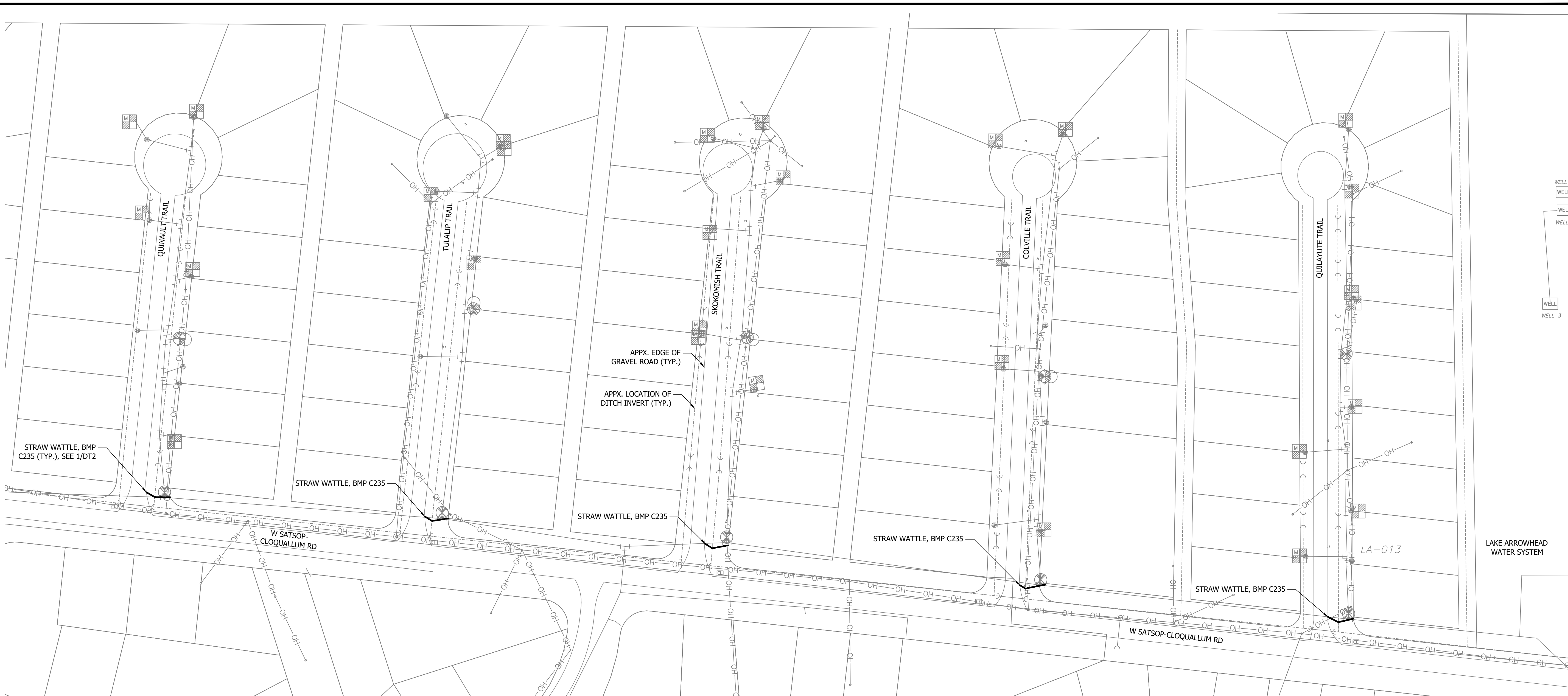

EROSION CONTROL NOTES

1. TEMPORARY STORMWATER AND EROSION CONTROL BMPs ARE REQUIRED TO BE IMPLEMENTED ACCORDING TO PROJECT PLANS PRIOR TO ANY GROUND DISTURBING ACTIVITIES.
2. AS CONSTRUCTION PROGRESSES AND SEASONAL CONDITIONS DICTATE, MORE EROSION AND STORMWATER CONTROL FACILITIES MAY BE REQUIRED TO ENSURE COMPLETE CONTROL OF THE SITE. IT SHALL BE THE OBLIGATION AND RESPONSIBILITY OF THE CONTRACTOR TO ADDRESS ANY NEW CONDITIONS AND PROVIDE ADDITIONAL FACILITIES AS NEEDED TO ACHIEVE PERFORMANCE STANDARDS.
3. NOTIFY PROJECT ENGINEER AND OWNER IF CONTAMINANTS ARE ENCOUNTERED DURING CONSTRUCTION.
4. WHERE POSSIBLE, MAINTAIN NATURAL VEGETATION FOR EROSION CONTROL. TOPSOIL SHOULD BE STRIPPED AND STOCKPILED IN DESIGNATED AREAS. TOPSOIL SHALL BE REPLACED ONCE TRENCH BACKFILL HAS BEEN PROPERLY COMPACTED AND AT ORIGINAL GRADE.
5. DUE TO WET CONDITIONS IN THE AREA, WORK SHALL NOT BE CONDUCTED DURING THE WET SEASON.
6. PLACE STRAW WATTLE AT SOUTHERN END OF CONSTRUCTION TO INTERCEPT ANY SEDIMENT POLLUTANTS GENERATED FROM EARTHWORK ACTIVITIES. INSTALL WATTLES ACCORDING TO 2014 SWMMWW BMP C235. LAY STRAW WATTLE FROM EDGE OF GRAVEL ROAD THROUGH DITCH INVERT AND EQUAL DISTANCE UP THE DITCH SLOPE.

2014 WA DOE SWMMWW 13 ELEMENTS NOTES

1. WHERE POSSIBLE, MAINTAIN NATURAL VEGETATION FOR EROSION CONTROL. TOPSOIL SHOULD BE STRIPPED AND STOCKPILED IN DESIGNATED AREAS. TOPSOIL SHALL BE REPLACED ONCE TRENCH BACKFILL HAS BEEN PROPERLY COMPACTED AND AT ORIGINAL GRADE. CONTRACTOR SHALL MARK ALL CLEARING LIMITS AND TRESS TO BE PRESERVED PRIOR TO TO CONDUCTING LAND DISTURBING ACTIVITIES.
2. STABILIZE ACCESS POINTS WITH CRUSHED ROCK TO MINIMIZE TRACKING OF SEDIMENT ONTO PUBLIC ROADS. CLEAN ALL ROADWAYS AND DISPOSE OF SEDIMENT AT THE END OF THE DAY.
3. PROTECT PROPERTIES FROM EROSION AND PREVENT INCREASES IN VELOCITY AND PEAK VOLUMETRIC FLOW RATES OF RUN-OFF CAUSED BY CONSTRUCTION. CONTRACTOR TO CONSTRUCT ADDITIONAL EROSION AND STORMWATER CONTROL BMPs TO MINIMIZE EROSION IF HIGH FLOWS CANNOT BE PREVENTED.
4. CONSTRUCT SEDIMENT CONTROL BMPs PER PLANS PRIOR TO ANY GROUND-DISTURBING ACTIVITIES AND TAKE ALL MEASURES NECESSARY TO MINIMIZE SEDIMENT DISCHARGES FROM THE SITE.
5. ALL DISTURBED LAND AREAS UNWORKED FOR SEVEN (7) DAYS OR MORE SHALL BE PROTECTED FROM EROSION BY HYDROSEEDING WITH A MIX OR METHOD APPROVED BY MASON COUNTY. ALL STOCKPILES SHALL BE PROTECTED FROM EROSION AND LOCATED AWAY FROM DRAINAGE CHANNELS.
6. PLACE EXCAVATED MATERIAL ON THE UPHILL SIDE OF TRENCHES. IMPLEMENT BMPs AS SHOWN ON PLAN TO REDUCE EROSION ON DITCH SLOPES. DO NOT DAMAGE DITCH SLOPES WITH HEAVY MACHINERY.
7. PROTECT EXISTING CULVERTS FROM EXCESSIVE SEDIMENTATION. CLEAN AND MAINTAIN CULVERTS AS NECESSARY TO NOT LIMIT ITS FLOW CAPACITY.
8. EXISTING ON-SITE CONVEYANCE CHANNELS AND DITCHES MUST BE PROTECTED FROM EROSION FROM RUN-OFF THROUGH USE OF BMPs SHOWN ON PLANS. CONTRACTOR MUST IMPLEMENT

2014 WA DOE SWMMWW 13 ELEMENTS NOTES CONT.

- ADDITIONAL PROTECTION MEASURES IF EROSION OCCURS WITHIN ROADSIDE DITCHES.
9. CONTRACTOR SHALL BE RESPONSIBLE FOR THE HANDLING AND DISPOSAL OF ALL POLLUTANTS CREATED FROM CONSTRUCTION ACTIVITIES, INCLUDING FUEL FOR EQUIPMENT. AN ON-SITE TREATMENT SYSTEM WILL BE REQUIRED FOR WHEEL WASH AND CONCRETE CLEAN-OUTS TO CONTAIN POLLUTANTS FOR PROPER DISPOSAL. DO NOT DISCHARGE POLLUTANTS INTO THE EXISTING DRAINAGE SYSTEM.
 10. DISCHARGE ONLY CLEAN, NON-TURBID DEWATERING WATER TO EXISTING DRAINAGE SYSTEM THROUGH A SEDIMENT BAG IN A MANNER THAT DOES NOT CAUSE EXCESSIVE EROSION OR FLOODING OF THE CHANNEL. HANDLE HIGHLY TURBID OR CONTAMINATED DEWATERING WATER SEPARATELY FROM STORMWATER.
 11. MAINTAIN EROSION AND SEDIMENT CONTROL BMPs ON A DAILY BASIS TO ASSURED CONTINUED PERFORMANCE IN ACCORDANCE WITH 2014 SWMMWW MANUAL. REMOVE ALL TEMPORARY BMPs WITHIN 30 DAYS AFTER FINAL SITE STABILIZATION HAS BEEN ACHIEVED.
 12. CONTRACTOR IS RESPONSIBLE FOR THE PROPER PERFORMANCE OF ALL BMPs IMPLEMENTED AND WILL REPAIR, MAINTAIN, OR ADD BMPs AS REQUESTED BY THE OWNER IN ORDER TO MEET EROSION CONTROL STANDARDS. CONTRACTOR SHALL PROVIDE PROJECT SCHEDULE IN ORDER TO REDUCE THE AMOUNT AND DURATION OF SOIL EXPOSED TO EROSION.
 13. THERE ARE NO LOW IMPACT DEVELOPMENT BMPs IMPLEMENTED FOR THIS PROJECT OR FOUND ON-SITE TO PROTECT.

LEGEND

- DITCH INVERT
- UG PUD3 LINES
- OH PUD3 LINES
- PUD3 POLES
- POLE GUY
- CENTURYLINK BOX
- CULVERT
- METER
- ⊕ VALVE
- STRAW WATTLE, BMP C235

LAKE ARROWHEAD WATERLINE REPLACEMENT EROSION CONTROL PLAN		MASON COUNTY PUD NO.1 N 21971 HWY. 101 SHELTON, WA 98584		0 REVISION	
BKI PROJECT NO: MA21-001 CONTRACT NO:		BKI ENGINEERING SERVICES Power in Partnership		4/27/21	
RAYN WHITEWOLF STATE OF WASHINGTON REGISTERED PROFESSIONAL ENGINEER 37437		TP DESIGNER		RW REVIEWER	
04/26/21		CONSTRUCTION PLANS		REVISION DESCRIPTION	
REV		DATE		REVISION DESCRIPTION	

K:\Mason #\064821\064821\PROJECTS\MA21-001 Lake Arrowhead Main Replacement\10 AUTOCAD\SHEETS\Lake Arrowhead Mainline Replacement_V0.dwg, Tom Rankau, 4/26/2021 4:13 PM

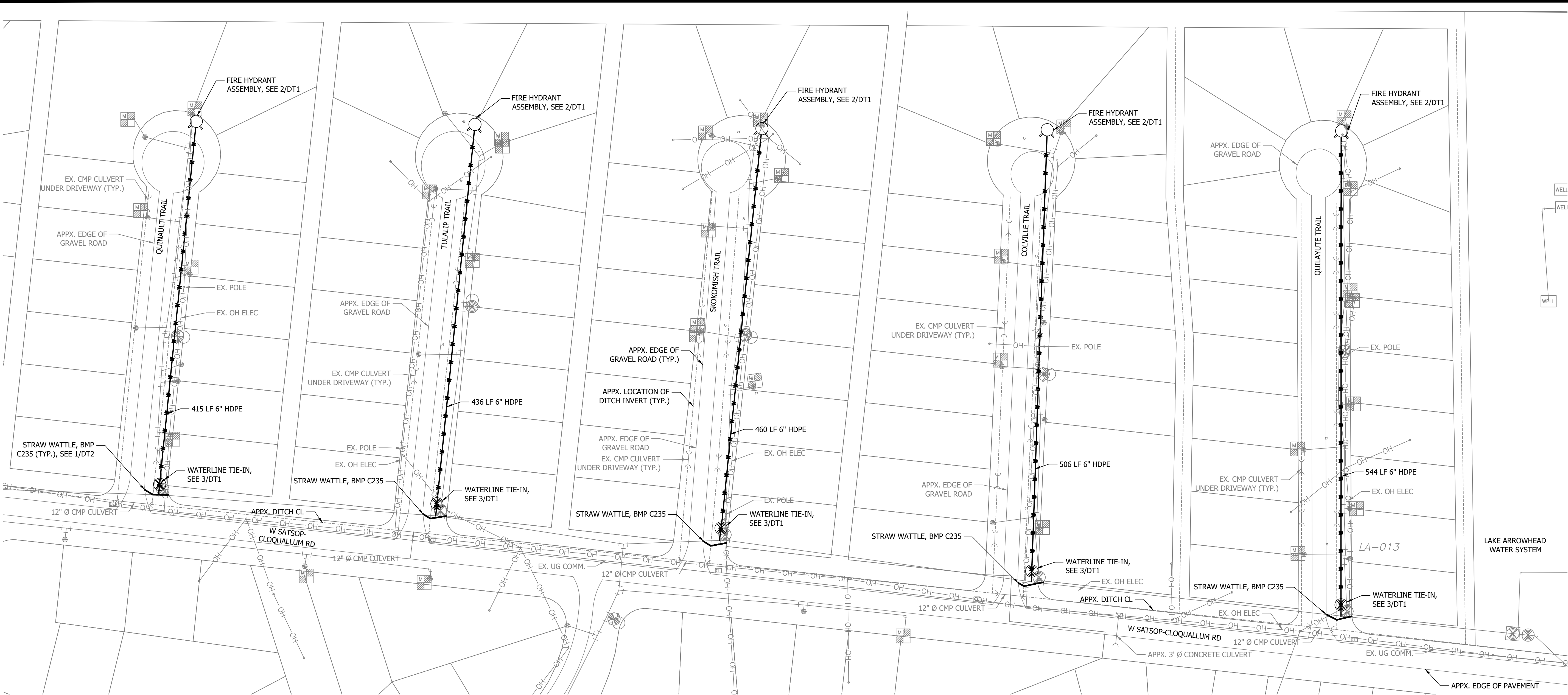

7-09.3(7)A - DEWATERING OF TRENCH

- WHERE WATER IS ENCOUNTERED IN THE TRENCH, IT SHALL BE REMOVED DURING PIPE-LAYING OPERATIONS AND THE TRENCH SO MAINTAINED UNTIL THE ENDS OF THE PIPE ARE SEALED AND PROVISION ARE MADE TO PREVENT FLOATING OF THE PIPE. TRENCH WATER OR OTHER DELETERIOUS MATERIALS SHALL NOT BE ALLOWED TO ENTER THE PIPE AT ANY TIME.

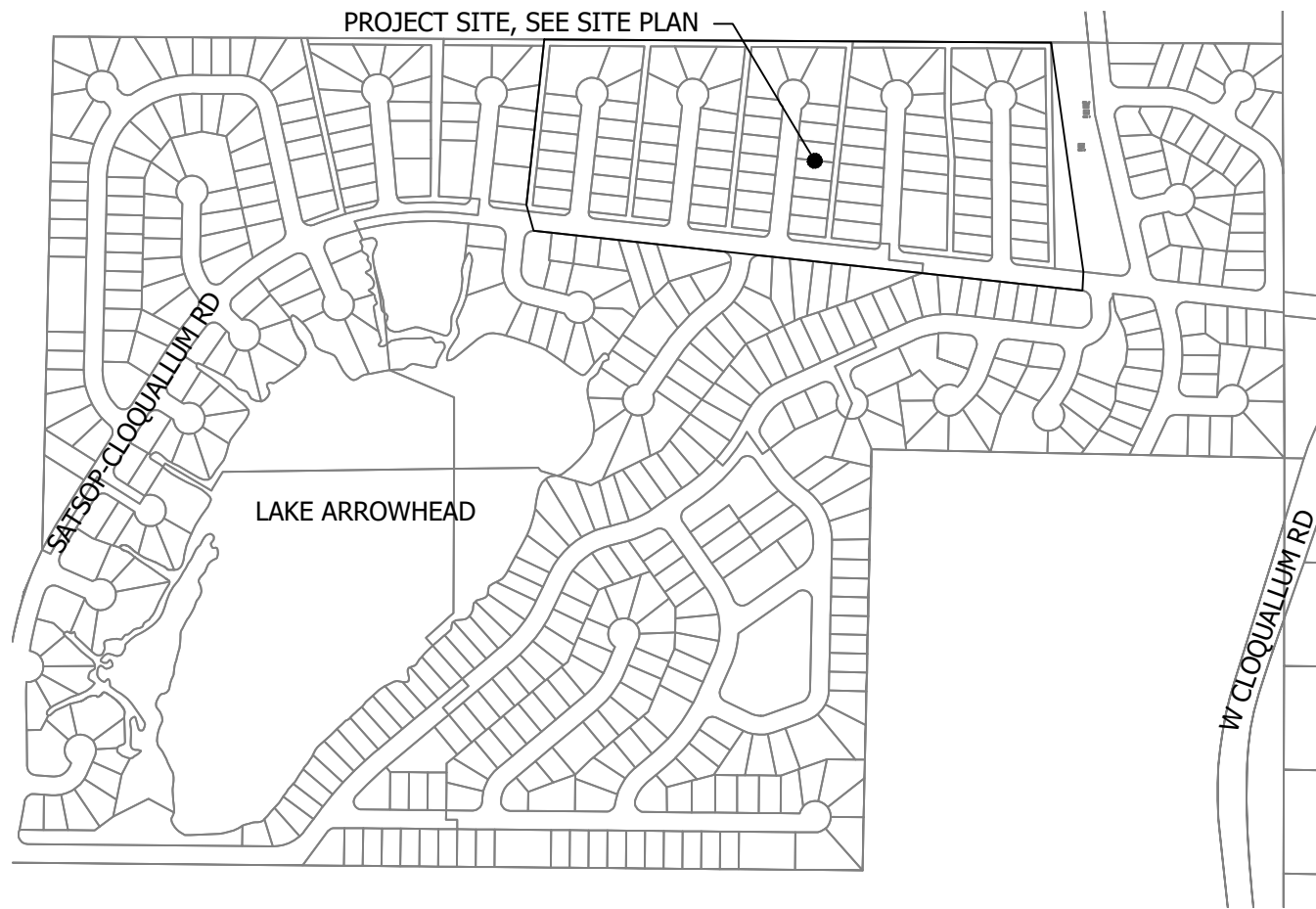

GENERAL NOTES

- LAKE ARROWHEAD MAINLINE REPLACEMENT PROJECT CONSISTS OF THE REPLACEMENT AND ABANDONMENT OF WATERLINES ALONG QUINAULT, TULALIP, SKOKOMISH, COLVILLE, AND QUILAYUTE TRAILS. PIPE LENGTHS NOTED ON PROJECT PLANS ARE APPROXIMATE. NEW GATEVALVES, FIRE HYDRANTS, AND OTHER APPURTENANCES WILL REQUIRE INSTALLATION AND EXISTING PARTS TO BE ABANDONMENT IN PLACE. QUANTITIES SHOWN ARE APPROXIMATE AND IT IS UP TO THE CONTRACTOR TO DETERMINE THE CORRECT QUANTITY OF APPURTENANCES AND LENGTH OF PIPE.
- ALL EXISTING FEATURES SHOWN ON SITE PLAN ARE APPROXIMATE IN LOCATION AND ONLY REPRESENT THE GENERAL LAYOUT OF THE SITE. NOT ALL FEATURES HAVE BEEN ACCOUNTED FOR. IT IS THE CONTRACTOR'S RESPONSIBILITY TO DETERMINE EXISTING CONDITIONS OF THE SITE TO DETERMINE THE CONSTRUCTABILITY OF THE PROJECT AND REFLECT IT AS SUCH IN THE BID PRICE.
- TEMPORARY STORMWATER AND EROSION CONTROL BMPS ARE REQUIRED TO BE IMPLEMENTED ACCORDING TO PROJECT PLANS PRIOR TO ANY GROUND DISTURBING ACTIVITIES. CONTRACTOR SHALL INSPECT AND MAINTAIN BMPS ON A WEEKLY BASIS, AS INDICATED ON TESC PAGE.
- DEWATERING ACTIVITIES MAY BE REQUIRED FOR TRENCHES IN THE AREA. GROUNDWATER ENCOUNTERED IN THE TRENCH SHALL BE DISCHARGED ON SITE THROUGH A SILTATION BAG INTO A SEDIMENT TRAP. DO NOT DISCHARGE POLLUTED GROUNDWATER TO THE SITE. DEWATERING SHALL BE CONDUCTED PER WSDOT STANDARD SPECIFICATION SECTION 7-09.3(7)A.
- UNLESS OTHERWISE NOTED HEREIN, ALL WORK SHALL BE IN ACCORDANCE WITH SECTION 7-09 OF THE WSDOT STANDARD SPECIFICATIONS.
- REFER TO PROJECT SPECIFICATIONS FOR PROPER DISINFECTION AND FLUSHING PROCEDURES.

WATER LINE NOTES

- MAINTAIN A MINIMUM 2'-0" CLEARANCE BETWEEN THE NEW WATERLINE AND EXISTING UTILITIES. NOTIFY ENGINEER AND OWNER OF ANY CONFLICTS IF CLEARANCES CANNOT BE MET.
- CONTRACTOR SHALL PREPARE THE ENTIRETY OF THE NEW WATERLINE, INCLUDING TESTING AND DISINFECTION, IN THE STREET PRIOR TO SWITCHING SERVICE WITH THE WATER TIE-IN, PER DETAIL 3/DT1. COORDINATE WITH MASON COUNTY PUD NO. 1 ON OUTAGES REQUIRED FOR TIE-IN.
- LOCATE APPURTENANCES THAT EXTEND TO SURFACE IN ROAD SHOULDER OR TOP OF DITCH WHEREVER POSSIBLE. DO NOT LOCATE APPURTENANCES WITHIN ANY DRIVEWAY OR THAT MAY CAUSE DISRUPTION TO TRAFFIC AND ACCESS.
- CONTRACTOR SHALL PERFORM HYDROSTATIC TESTING PER PROJECT SPECIFICATIONS, MASON COUNTY PUD NO. 1 DESIGN STANDARDS, AND WSDOT STANDARD SPECIFICATIONS SECTION 7-09.3(23). CONTRACTOR SHALL FIX LEAKING APPURTENANCE OR PIPE AT HIS OWN EXPENSE.
- AFTER COMPLETION OF HYDROSTATIC PRESSURE TESTING, CONTRACTOR SHALL PERFORM DISINFECTION ON THE WATER MAIN ACCORDING TO WSDOT STANDARD SPECIFICATIONS SECTION 7-09.3(24).

MATERIAL & STANDARD REQUIREMENTS

- HDPE PIPE MATERIAL SHALL CONFORM TO AWWA C906, ASTM D2239, ASTM D2737, ASTM D3035, AND ASTM F714 STANDARDS. HDPE PIPE USED SHALL BE PRESSURE RATED AT DR 26 (80 PSI) OR GREATER PRESSURE RATINGS. BUTT FUSION AND MATERIAL REQUIREMENTS OF ALL HDPE PIPES AND RELATED PARTS SHALL CONFORM TO ASTM D3261, ASTM F1055, ASTM F2206, AND ASTM F2620 STANDARDS. HEAT FUSION OPERATIONS SHALL ONLY BE CONDUCTED BY QUALIFIED PERSONNEL THAT MEET ASTM F3190 STANDARDS.
- DUCTILE IRON MATERIAL AND RELATED PARTS TO CONFORM TO AWWA C110, C11, C115, C116, C150, C151, AND C153 STANDARDS. DUCTILE IRON MATERIALS TO BE INSTALLED ACCORDING TO AWWA C600 STANDARDS.
- ALL MATERIAL IN CONTACT WITH POTABLE WATER SHALL BE NSF-61 APPROVED. ALL MATERIAL TO BE APPROVED BY OWNER PRIOR TO PURCHASE.

LEGEND

---	DITCH INVERT		GATE VALVE ASSEMBLY, SEE 1/DT1
---	UG PUD3 LINES		FIRE HYDRANT ASSEMBLY, SEE 2/DT1
-OH-	OH PUD3 LINES		WATER LINE
o	PUD3 POLES		STRAW WATTLE, BMP C235
---	POLE GUY		
	CENTURYLINK BOX		
	CULVERT		
	METER		
	VALVE		
	FIRE HYDRANT		

LAKE ARROWHEAD WATERLINE REPLACEMENT		SITE PLAN		MASON COUNTY PUD NO.1 N 21971 HWY. 101 SHELTON, WA 98584	
0		REVISION		0	
TP		DESIGNER		RW	
0		04/26/21		CONSTRUCTION PLANS	
REV		DATE		REVISION DESCRIPTION	
4/27/21		REGISTERED PROFESSIONAL ENGINEER		37437	
RYAN WHITEWOLF		STATE OF WASHINGTON		4/27/21	
BKI		ENGINEERING SERVICES		Power in Partnership	
BKI PROJECT NO: MA21-001		CONTRACT NO:		THIS LINE IS 1" LONG AT THE CORRECT SCALE	
SP1		5 / 7			

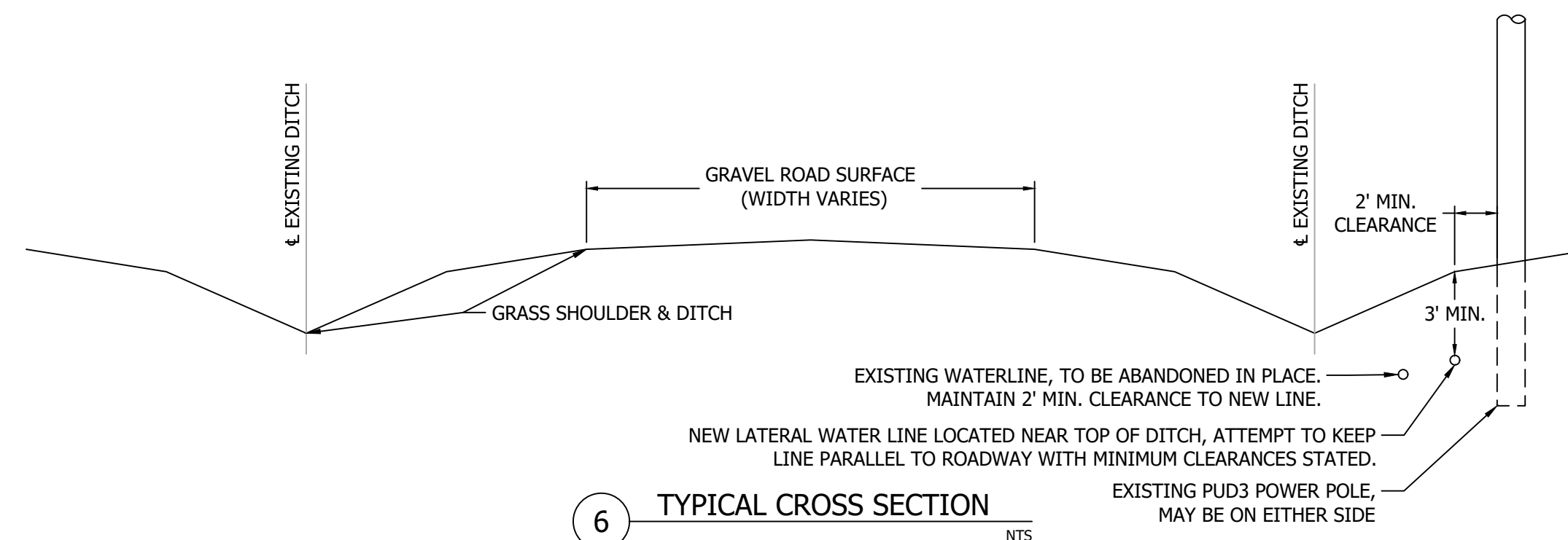
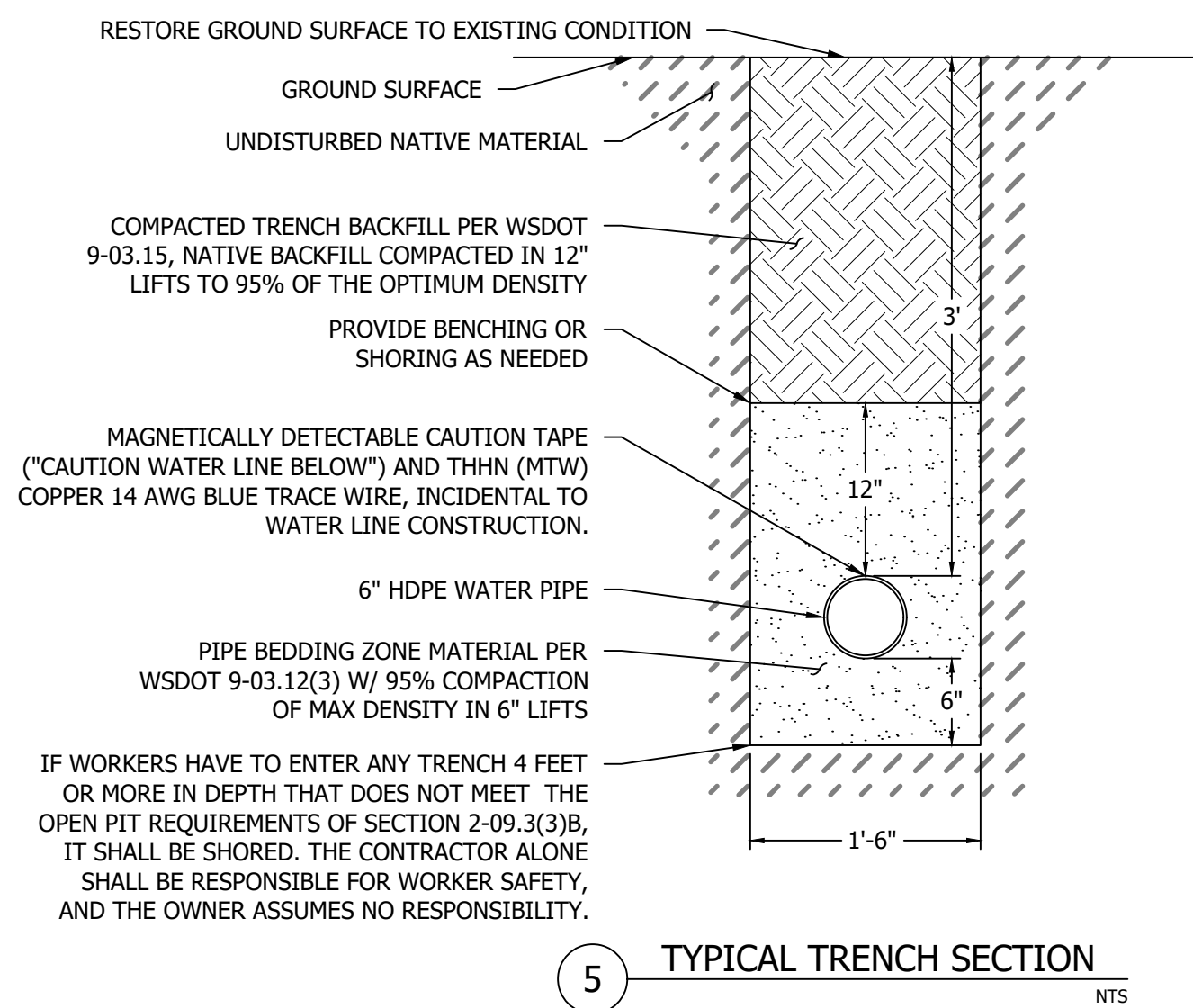
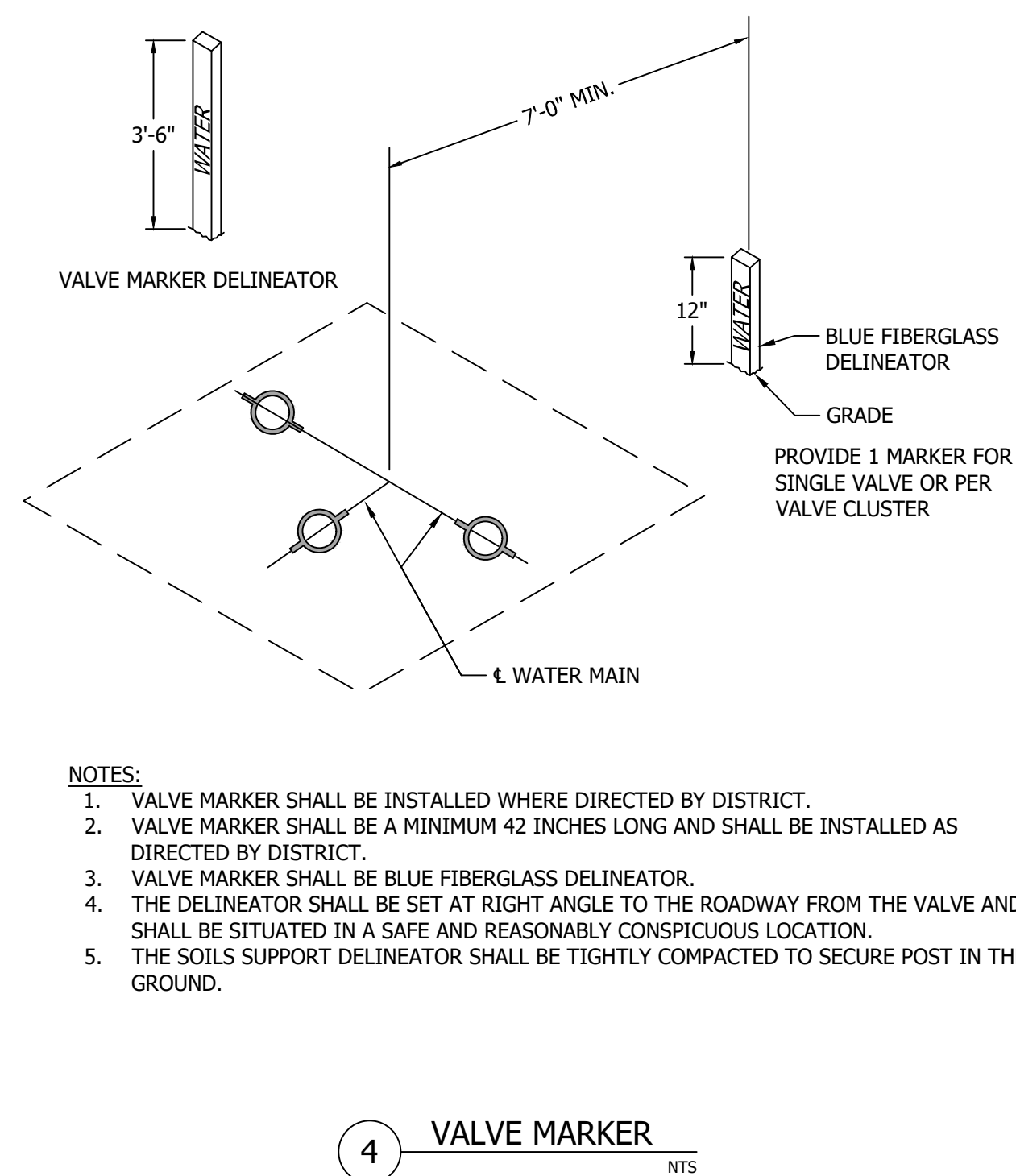
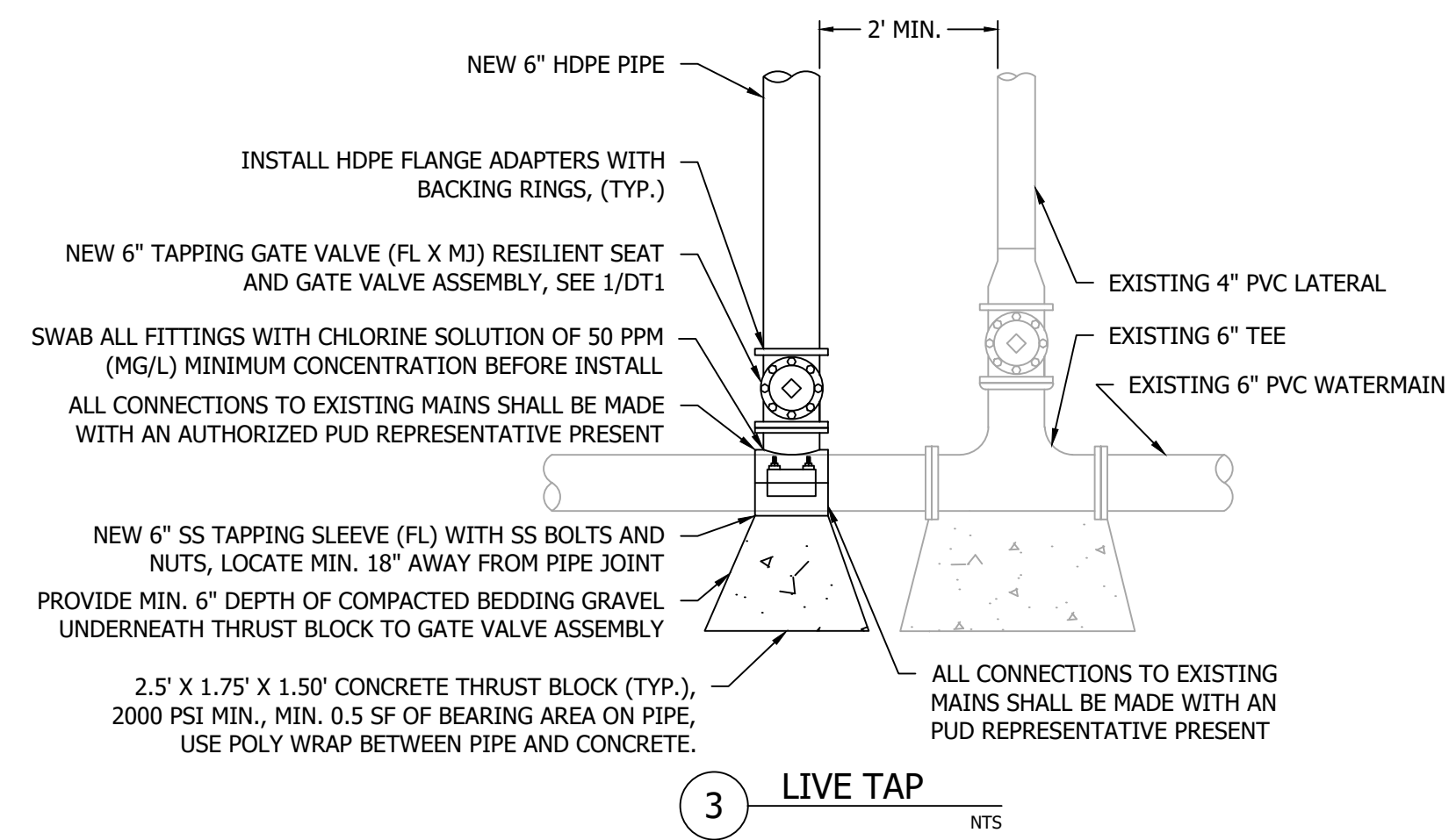
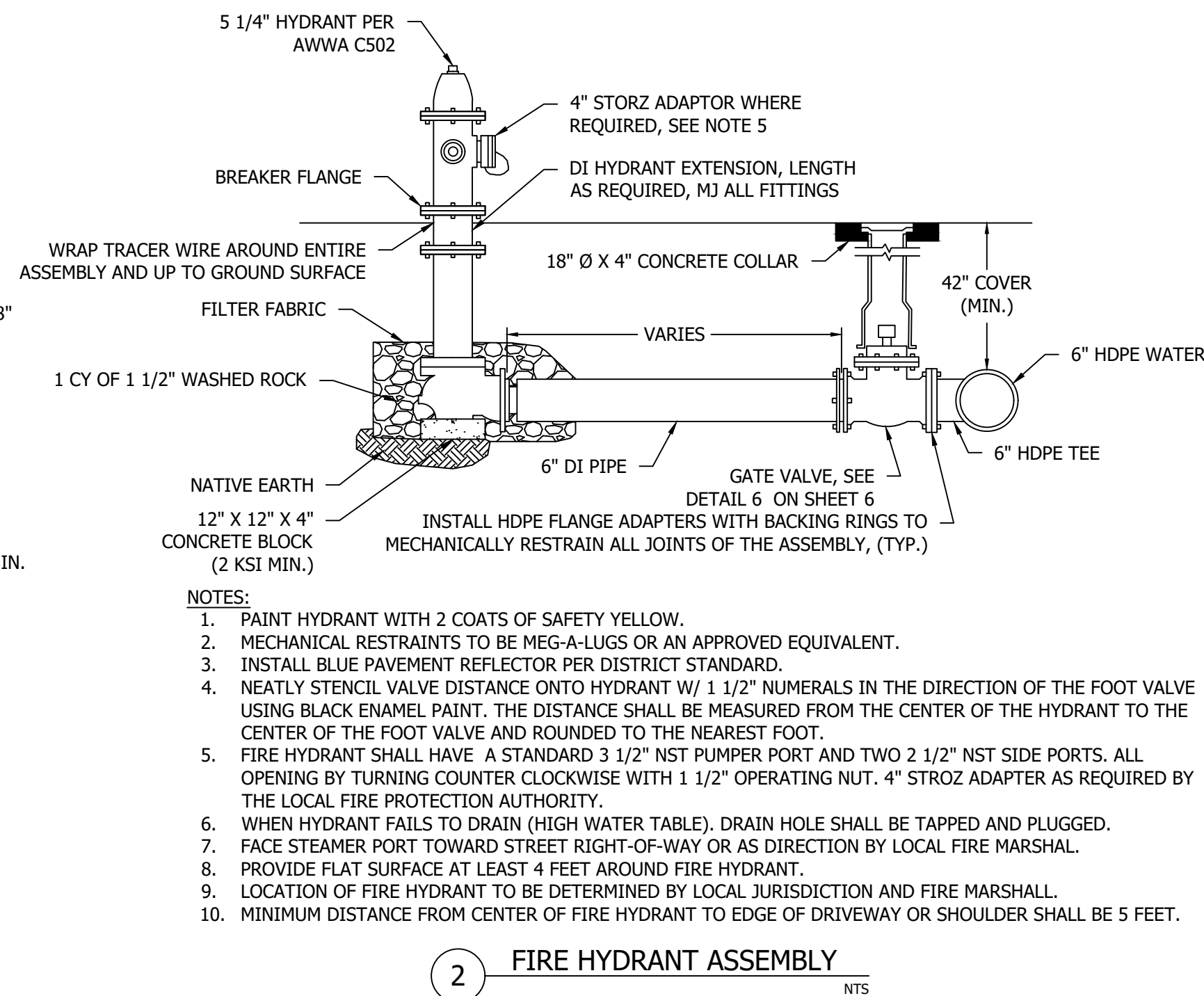
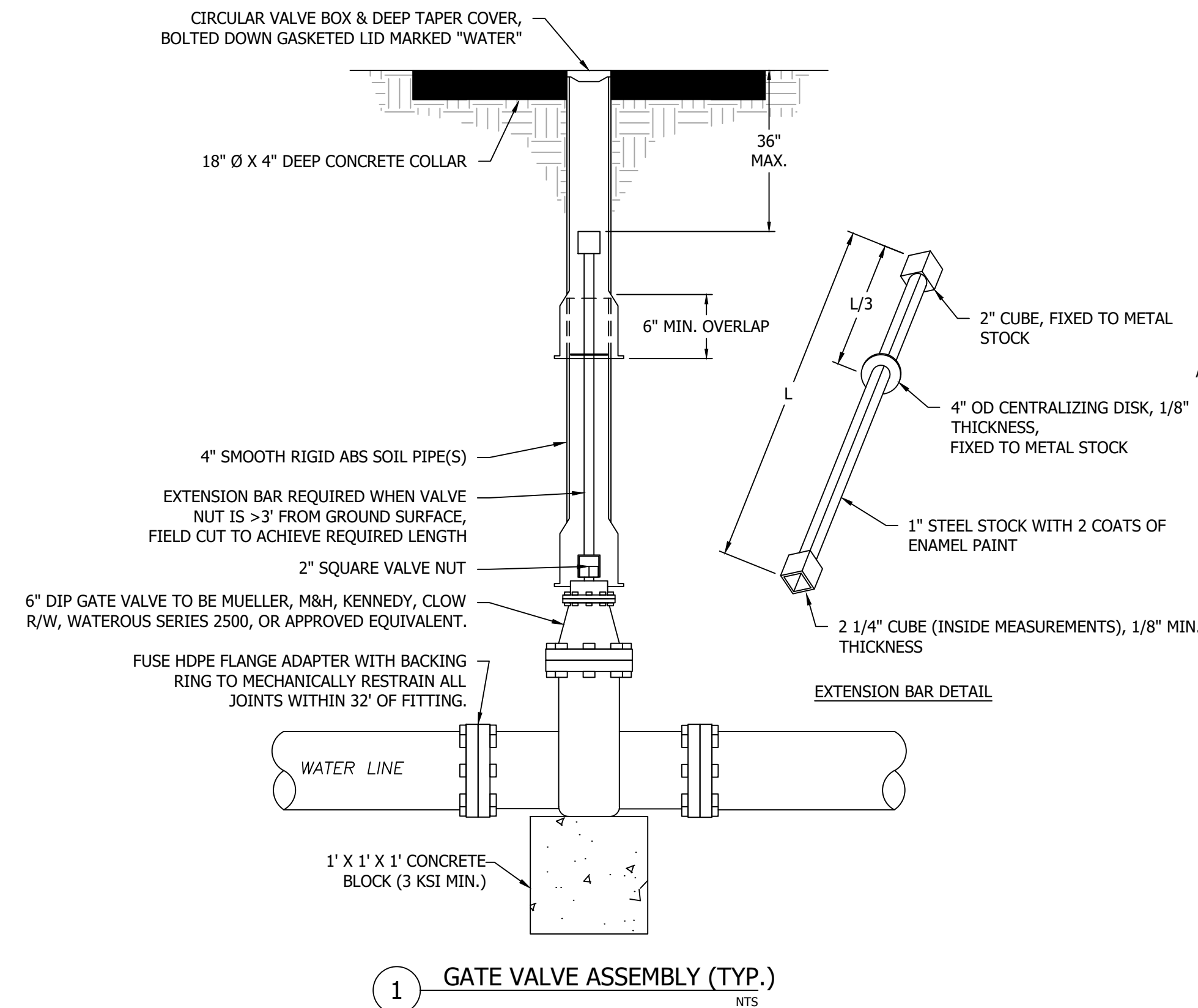

NOTE: NO SEPARATE PAYMENT WILL BE MADE FOR CLEARING AND GRUBBING, REMOVAL OF EXISTING STREET IMPROVEMENTS, FURNISHING AND INSTALLING SAND CUSHION, PROTECTION OF EXISTING UTILITIES AND SERVICES, TRENCH EXCAVATION AND BACKFILL, BEDDING THE PIPE, AND COMPACTING THE BACKFILL. THESE ITEMS SHALL ALL BE CONSIDERED AS INCIDENTAL TO THE WORK OF CONSTRUCTING THE WATER MAIN, AND ALL COSTS THEREOF SHALL BE INCLUDED IN THE PAYMENT AS SPECIFIED IN SECTION 7-09.5.

[illegible]

